

Weekly Construction Progress Report



Client:	The Nature Conservancy
Project Name:	Wannemacher Nature Reserve
Project Location:	Miami County, Ohio
Date:	WE 10/27/2023

Description of Work Performed	Notes
Corridor clearing, rough and final grading, toewood revetment, and rock riffle construction	<p>Harvest and stockpiling of topsoil, on-site boulders, timber and woody debris continued in-tandem with corridor clearing and channel realignment, extending upstream of the pedestrian bridge to approx Sta 2+00.</p> <p>Construction of the new channel continued between Sta 12+00 to 2+00, including finished grading, seeding, and erosion control blanket (ECB) installation along both streambanks, up to the toewood revetment near Sta 11+00. Rough grading continued in preparation for construction of bank treatments and instream structures up to Sta 2+00.</p> <p>Boulder toe with branch packing and root wads was constructed along the right descending bank (RDB) from approx Sta 11+00 to 12+00. Rock riffles were installed upstream of the pedestrian bridge at Sta 8+60 and 6+60. The foundation excavation of the riffle at Sta 9+68 was surveyed and modified to lower the downstream (tail) elevation by approx 1 foot, in order to preserve the existing freeboard depth between the channel bed and bottom chord elevation of the pedestrian bridge.</p> <p>Excavation of the north and south wetland areas were discussed with TNC. The pattern of individual wetland pools will be further modified for increased diversity of pattern and dimension. Excavated soils from the wetland areas were hauled to the spoils/overlook areas.</p>

Inspector: B. Kwiatkowski	Date Submitted: 10/27/2023
Reviewed By: C. Straub	Company: Davey Resource Group, Inc.



Photograph 1: Channel grading and constructed riffle near pedestrian bridge at Sta 10+50.



Photograph 2: Channel grading, boulder toe w branch packing and toewood revetment downstream of 11+50.



Photograph 3: Constructed rock riffle near Sta 8+80.

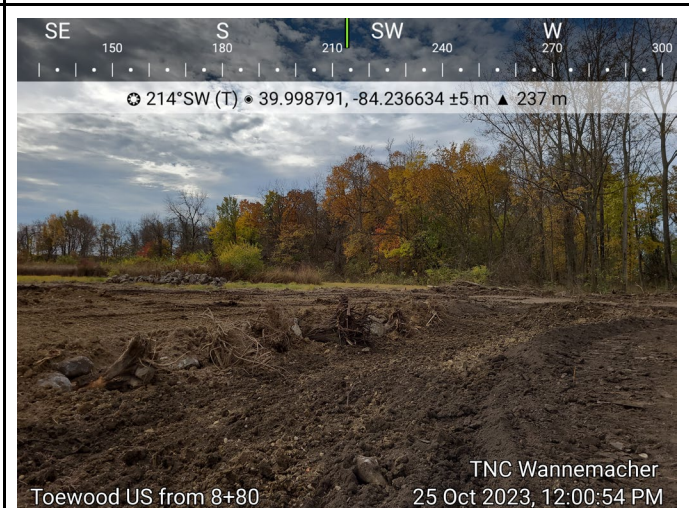

Photograph 4: Toewood revetment along south bank, upstream of Sta 8+80.